



electric instantaneous water heater

Most important advantages



Copper shielded heating elements
Reliable technology ensures long life, resistance to water decay and air bubbles.



Power regulation
Allows to set the heater on full power or economic mode.



Automatically switches on 2 steps of heating
Automatic "switch on" system and power selection according to the water flow rate.



Regulating valve
allows for setting comfortable temperature at a maximum possible flow of water.



Modern design

Application

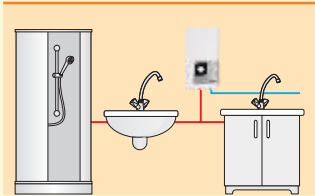

12-15kW

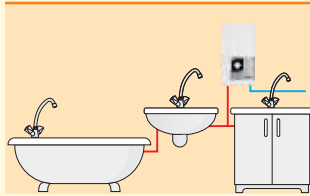

from 18kW

Technical data

Type	KDH Luxus hydraulic						
Rated power	kW	9	12	15	18	21	24
Rated voltage		400V 3~					
Rated current	A	3x13,0	3x17,3	3x21,7	3x26,0	3x30,3	3x34,6
Fuse rated current	A	16	20	25	32	40	
Min. connecting wires section	mm ²	4x1,5	4x2,5		4x4	4x6	
Efficiency (at 30°C/ 86°F temp. rise)	l/min	4,3	5,8	7,2	8,7	10,1	11,6
Supply water pressure	MPa	0,15 ÷ 0,6					
Dimensions	mm	440 x 245 x 120					
Weight	kg	~ 5,1					
Inlet and outlet section		Gw 1/2"					
Distance between inlet and outlet	mm	~100					
Safety class		IP 25					

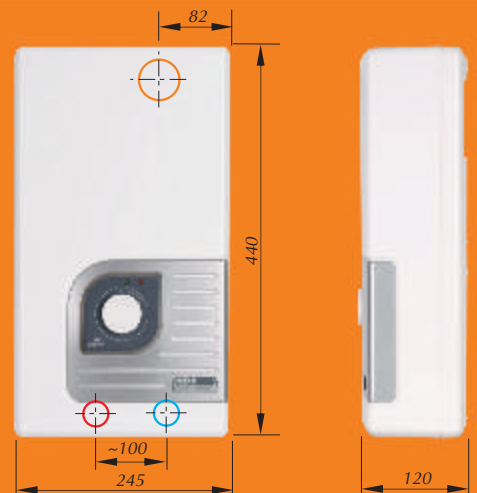

All technical data is based on standards of Central European countries. However, Kospel S.A. is fully flexible to adjust its appliances to other standards.