

# electronic FOCUS

**suitable for solar panels  
and heat pumps**

## electric instantaneous water heater

### Most important advantages

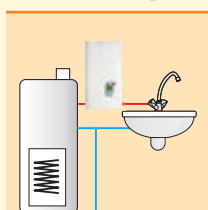

#### Suitable for cooperation with solar panels and heat pumps

Can work on already pre-heated water. Inletting water temperature up to 70°C.



#### LCD

The display allows to read the inlet and outlet temperatures, the flow rate and current power consumption.



#### Protection from air bubbles

Electronic system after detecting air bubbles cuts off power supply and protects the heating element from burning-out.



#### Priority switch

Water heater is able to cooperate with another electric high power consumption appliance.



#### Water flow sensor

Sensor operates at very low pressure 0,2MPa and water flow as little as 2,5 l/min.

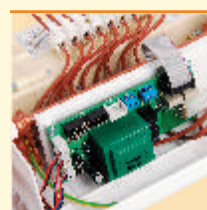

#### Electronic control system

ensures stability and smooth regulation of water temperature from 30°C to 60°C (1°C step).

### Application

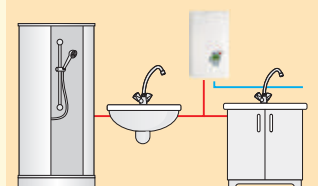

from 15kW

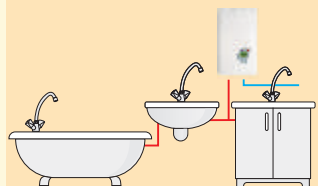

from 18kW

### Technical data

Type	EPVE Focus electronic				
Rated power	kW	15	18	21	24
Rated voltage		400V 3~			
Rated current	A	3x21,7	3x26,0	3x30,3	3x34,6
Fuse rated current	A	25	32	40	
Min. connecting wires section	mm <sup>2</sup>	4x2,5	4x4		4x6
Efficiency (at 40°C/ 104°F temp. rise)	l/min	5,4	6,5	7,6	8,7
Supply water pressure	MPa	0,2 ÷ 0,6			
Dimensions	mm	440 x 250 x 105			
Weight	kg	~ 3,5			
Inlet and outlet section		Gw 1/2"			
Distance between inlet and outlet	mm	~75-110			
Safety class		IP 24			

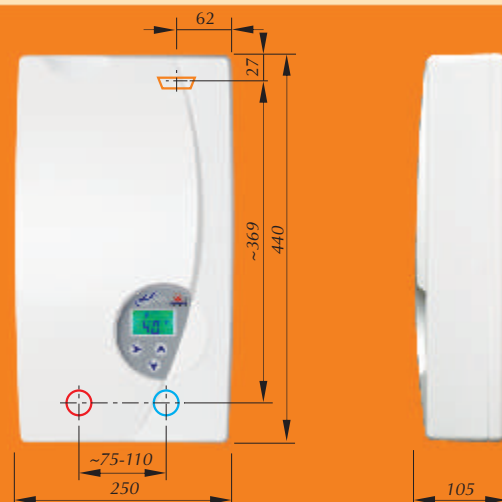

All technical data is based on standards of Central European countries. However, Kospel S.A. is fully flexible to adjust its appliances to other standards.